

## From the Headteacher...

It has been a good first full week back for the Spring term with the children settling back into routines well.

### Design competition

We have invited a professional artist to create an inspiring painted mural in our school entrance area. This will transform the current bland and empty space you see below, into a vibrant and welcoming area that children, parents and visitors can enjoy when we enter the school building.

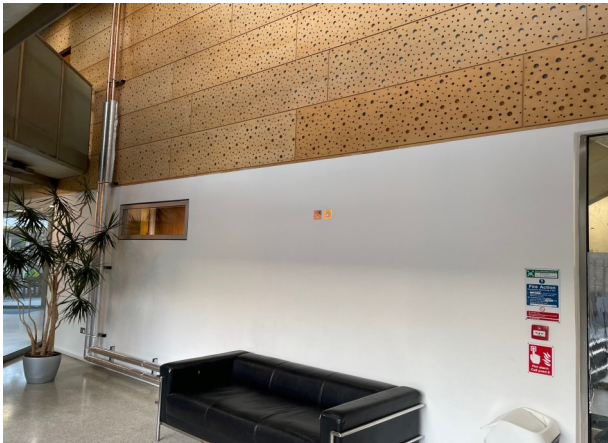

However, we would like the children's input in this. As an *optional* additional piece of whole school homework this week, we are giving the children the chance to have a say in the mural that is created. Each teacher has discussed this with their class and given them further details of what we are hoping to achieve. Children should submit their designs on a landscape plain A4 paper and hand to your class teacher by **Friday 21st January**. The best entries will have their design included in the final mural that will be completed during the Spring term.

### Parent Coffee Morning

A reminder that our next Parent Coffee Morning will be held on **Thursday 27<sup>th</sup> January 9:00am – 10:00am**. For the time being, this will unfortunately be a virtual Teams meeting. Please click [here](#) for the link for the meeting. This will also be sent out again closer to the time. The purpose of this meeting will be for members of the leadership team to be available to listen to your thoughts and feedback about what is going really well at Clapham Manor and also what we could do even better at. We are keen to continue to develop the use of our new school website and the information available to parents about children's learning and we would be particularly interested to hear your feedback about this. I look forward to seeing you there.

Have a great weekend!

Mr Broad

## Diary Dates

### YEAR 4 RESIDENTIAL INFORMATION MEETING

**Thursday 20th January 2022 at 6pm**

### EARHART SHARING ASSEMBLY

**Friday 21st January 2022 at 9.15am**

### YEAR 5 ROYAL OBSERVATORY TRIP

**Tuesday 25th January 2022**

### PARENT/CARER WORKSHOP

**(Assessment Information for Year 6)**

**Tuesday 26th January 2022 at 6pm**

### PARENT/CARER COFFEE MORNING

**Thursday 27th January 2022 at 9am**



## Workshops & Trips

### Year 4 Residential Information Evening

Thursday 20th January 2022 at 6pm

Teams Link:

### Microsoft Teams meeting

Join on your computer or mobile app

[Click here to join the meeting](#)

[Learn More](#) | [Meeting options](#)

### Year 6 SATs Information Evening

Tuesday 25th January at 6pm

Teams Link:

### Microsoft Teams meeting

Join on your computer or mobile app

[Click here to join the meeting](#)

[Learn More](#) | [Meeting options](#)



On **Wednesday 23<sup>rd</sup> February 2022**, Ms Turner will be leading a parent workshop based around anti-racism, including what the school is doing to promote anti-racism and how you as parents can support your child in discussing this difficult but important issue.

This will be a virtual meeting and the link will be shared nearer the time. All are welcome!



## Star Class

W/C 3rd January was Jemison with 98.6% and  
W/C 10th January was also Jemison 98.5%.

Congratulations to 2 Jemison!

Well done to everyone who is getting to school  
on time every day, every minute counts!

We look forward to seeing who will be our star  
class next week!

## Raising the Game

1 or 2 days a week doesn't seem much but.....

If your child misses.....	That equals....	Which is.....	and over 13 years of schooling that's.....
1 day per fortnight	20 days per year	4 weeks per year	nearly 1½ years
1 day per week	40 days per year	8 weeks per year	over 2 ½ years
2 days per week	80 days per year	16 weeks per year	over 5 years
3 days per week	120 days per year	24 weeks per year	nearly 8 years

How about 10 minutes late a day? Surely that won't affect my child?

He/She is only missing just.....	That equals.....	Which is.....	& over 13 years of schooling that's...
10 mins per day	50 mins per week	nearly 1½ weeks per year	nearly ½ year
20 mins per day	1hr 40mins per week	over 2 ½ weeks per year	nearly 1 year
30 mins per day	Half a day per week	4 weeks per year	nearly 1½ years
1 hour per day	1 day per week	8 weeks per year	over 2½ years

## Every Day Counts

If you want your child to be successful at school then  
**YES, attendance does matter!**



## Our Learning

Year 5 made parachutes in science this week to test air resistance.



## Thank you!

A big thank you to the year 5 parents for helping us buy new dictionaries for our classroom.

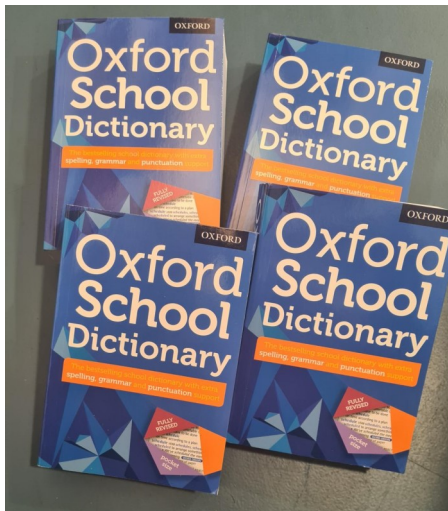

## Clubs



Join Fit For Sport at our Extended School Clubs available every day throughout the term – secure your child's spot for the new Spring Term!

New year, means new opportunities to be active, have fun and get moving! Fit For Sport Extended School Clubs in 2022 will be immersed with a whole host of new activities for children this new Spring Term where they can enjoy discovering fun facts and learning about the aviators of the animal kingdom with our Big Garden Bird Watch; becoming the authors of their own imagination and bringing their favourite stories to life with our Storytelling week; as well as taking on our new skills week in February that looks to unearth those hidden talents and inspire a passion for something new!

With so many families already securing their child/ren's spots - ensure your child doesn't miss out on all the pulse-raising activities this year by securing their spot for the academic year now through our flexible payment options that includes – book now, pay late by using our handy instalment plan – you can spread the cost of your termly or yearly bookings through manageable monthly instalments and ensure your child misses a moment!

Book now at: <https://www.fitforsport.co.uk/extended-school-clubs>

If you have any further queries, please don't hesitate to call Fit For Sport's friendly bookings team on 0208 742 4990 or drop them an email at [enquiries@fitforsport.co.uk](mailto:enquiries@fitforsport.co.uk).



## From the PTA...

### Winter Sale Success

We would like to say a huge Thank You to everyone for making our Winter Sale a success, despite having to cancel the Winter Fair. We raised a total of **£1,765!**



Now it's time to plan for the next event! If you are interested in getting involved, read on...

### The PTA is recruiting!

We are looking for a few more people to join the PTA core team this year. If you are interested or would like to learn more about any of the roles below, please contact [PTA@clapham-manor.co.uk](mailto:PTA@clapham-manor.co.uk)

#### Event Coordinator

- Come up with ideas for events/COVID bubble events
- Research significant celebration days
- Coordinate volunteers for events
- Attend and read minutes from meetings

#### Fundraising Coordinator

- Come up with ideas for sponsorship
- Manage sponsorship deals and relationships
- Grant writing
- Attend and read minutes from meetings

#### Classlist Coordinator

Classlist is a new platform for the PTA. We hope this tool will enable us to build the school community and boost our communication with parents/carers. Please visit the [Classlist website](#) to learn more about it for

now. We will share more on this very soon!

- Keep up-to-date with the Classlist features
- Monitor and maintain Classlist community
- Configure Classlist for fundraising events and activities
- Attend and read minutes from meetings

Do you have an interest in getting to know the parents in the school community more? Becoming more integrated into the school community? Helping to make children's educational experiences fun and engaging, as well as learn new skills? Then one of these roles may be just for you!

## Well Done!



Wilberforce were this week's house winners with an amazing 297 points! Well done Wilberforce.

We look forward to seeing who will be our house winners next week

Reception classes are on the hunt for dinosaur/palaeontologist related things for our new topic 'Dinosaurs'.

- We are on the hunt for:
- observation tools
- old cameras
- Binoculars
- large magnify glasses
- digging tools
- large paintbrushes
- small paintbrushes

